



Commercial & Industrial Real Estate
Brokerage / Management Services
www.burchkiser.com

Property For: **Sale**



DESCRIPTION

SPECIFICATIONS

HIGH INTERSTATE VISIBILITY

Marketed as vacant ground

1.86 Acres zoned CG - Commercial (City of Champaign). Located at NE quad of I-74 and North Mattis Avenue, Champaign. I-74 exposure with great signage available.

- Frontage along Anthony Dr.
- Easy ingress / egress
- All Utilities to site
- Located across from the future medical campus for Carle Hospital
- Residential, multiple family, office, and retail development all taking place in immediate area
- Daily Traffic:

Mattis Avenue	15,000
Interstate 74	39,400
Anthony Drive	6,600
- Excellent visibility from I-74
- **Price: \$300,000**

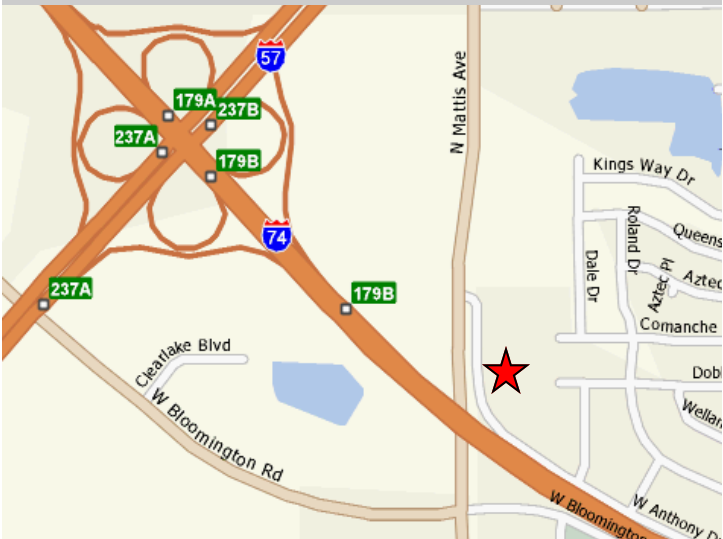

MORE INFORMATION?

For additional information, please contact John Kiser at 217-359-8333. Burch Kiser Real Estate is the agent for, and therefore represents, the Seller.
Office: 511 N Neil St., Champaign, IL 61820

GIS Webmap Public Interface Champaign County, Illinois



This map application was prepared with geographic information system (GIS) data created by the Champaign County GIS Consortium (CCGIS), or other CCGISC member agency. These entities do not warrant or guarantee the accuracy or suitability of GIS data for any purpose. The GIS data within this application is intended to be used as a general index to spatial information and not intended for detailed, site-specific analysis or resolution of legal matters. Users assume all risk arising from the use or misuse of this application and information contained herein. The use of this application constitutes acknowledgement of this disclaimer.